

Penn Park Basketball

Madison, WI

Lighting System

Pole / Fixture Summary					
Pole ID	Pole Height	Mtg Height	Fixture Qty	Luminaire Type	Circuit
P1-P4	40'	40'	2	TLC-LED-600	A
4			8		
				1.16 kW	
				4.64 kW	

Circuit Summary			
Circuit	Description	Load	Fixture Qty
A	Courts	4.64 kW	8

Fixture Type Summary							
Type	Source	Wattage	Lumens	L90	L80	L70	Quantity
TLC-LED-600	LED 5700K - 75 CRI	580W	65,600	>120,000	>120,000	>120,000	8

Light Level Summary

Calculation Grid Summary							
Grid Name	Calculation Metric	Illumination			Circuits	Fixture Qty	
		Ave	Min	Max			
Courts	Horizontal Illuminance	30.2	20	45	A	8	
Property Line	Horizontal	0.14	0	0.43	A	8	

From Hometown to Professional

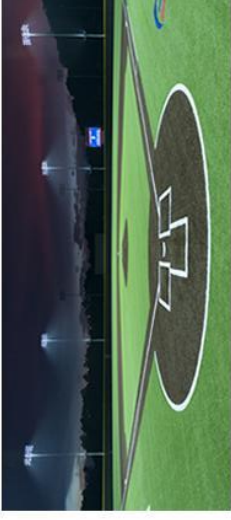

We Make It Happen®

Not to be reproduced in whole or part without the written consent of Musco Sports Lighting, LLC. ©1981, 2022 Musco Sports Lighting, LLC.

Penn Park Basketball Madison, WI

GRID SUMMARY

Name: Courts
Size: 169' x 97'
Spacing: 20.0' x 20.0'
Height: 3.0' above grade

ILLUMINATION SUMMARY

MAINTAINED HORIZONTAL FOOTCANDLES

Entire Grid

Guaranteed Average: 25

Scan Average: 30.22

Maximum: 45

Minimum: 20

Avg / Min: 1.53

Guaranteed Max / Min: 4

Max / Min: 2.27

UG (adjacent pts): 1.47

CU: 0.75

No. of Points: 34

LUMINAIRE INFORMATION

Applied Circuits: A

No. of Luminaires: 8

Total Load: 4.64 kW

Guaranteed Performance: The ILLUMINATION described above is guaranteed per your Musco Warranty document and includes a 0.95 dirt depreciation factor.

Field Measurements: Individual field measurements may vary from computer-calculated predictions and should be taken in accordance with IESNA RP-6-15.

Electrical System Requirements: Refer to Amperage Draw Chart and/or the "Musco Control System Summary" for electrical sizing.

Installation Requirements: Results assume ± 3% nominal voltage at line side of the driver and structures located within 3 feet (1m) of design locations.



We Make It Happen®

Not to be reproduced in whole or part without the written consent of Musco Sports Lighting, LLC. ©1981, 2022 Musco Sports Lighting, LLC.

ILLUMINATION SUMMARY

EQUIPMENT LIST FOR AREAS SHOWN

Pole		Luminaires					
QTY	LOCATION	SIZE	MOUNTING HEIGHT	LUMINAIRE TYPE	QTY / POLE	THIS GRID	OTHER GRIDS
4	P1-P4	40'	40'	TLC-LED-600	2	2	0
TOTALS					8	8	0

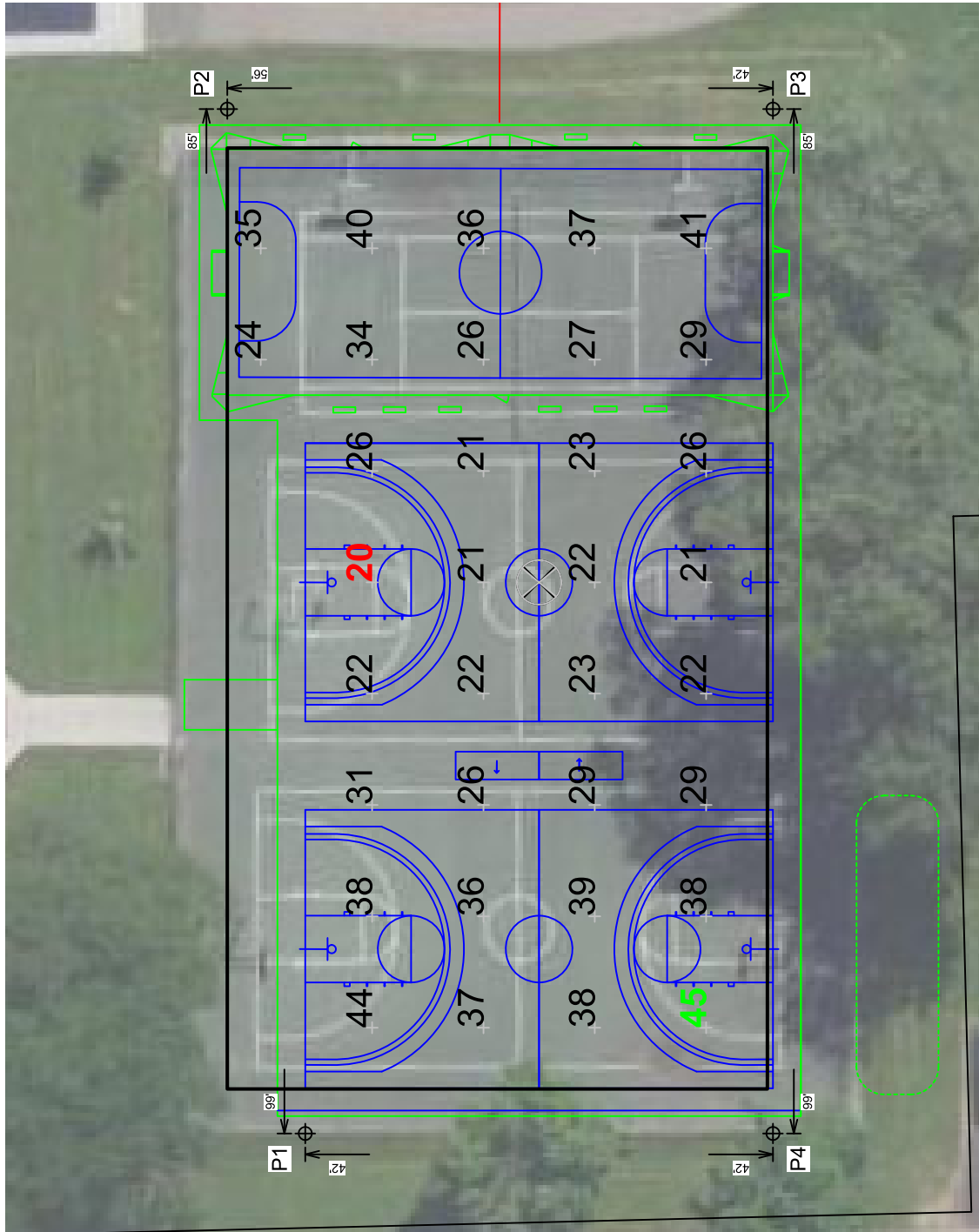

Pole location(s) Ⓢ dimensions are relative to 0,0 reference point(s) ⊗

SCALE IN FEET 1 : 30



ENGINEERED DESIGN By: Connor Ramstead · File #224333B · 21-Dec-22

EQUIPMENT LIST FOR AREAS SHOWN

Pole		Luminaires						
QTY	LOCATION	SIZE	GRADE ELEVATION	MOUNTING HEIGHT	LUMINAIRE TYPE	QTY / POLE	THIS GRID	OTHER GRIDS
4	P1-P4	40'	-	40'	TLC-LED-600	8	8	0
TOTALS						8	8	0

Penn Park Basketball Madison, WI

GRID SUMMARY

Name: **Property Line**
 Spacing: 30.0'
 Height: 3.0' above grade

ILLUMINATION SUMMARY

HORIZONTAL FOOTCANDLES

Entire Grid
Guaranteed Average: 25
 Scan Average: 0.1413
 Maximum: 0.43
 Minimum: 0.00
 No. of Points: 18

LUMINAIRE INFORMATION

Applied Circuits: A
No. of Luminaires: 8
 Total Load: 4.64 kW

Guaranteed Performance: The ILLUMINATION described above is guaranteed per your Musco Warranty document.

Field Measurements: Individual field measurements may vary from computer-calculated predictions and should be taken in accordance with IESNA RP-6-15.

Electrical System Requirements: Refer to Amperage Draw Chart and/or the "Musco Control System Summary" for electrical sizing.

Installation Requirements: Results assume ± 3% nominal voltage at line side of the driver and structures located within 3 feet (1m) of design locations.

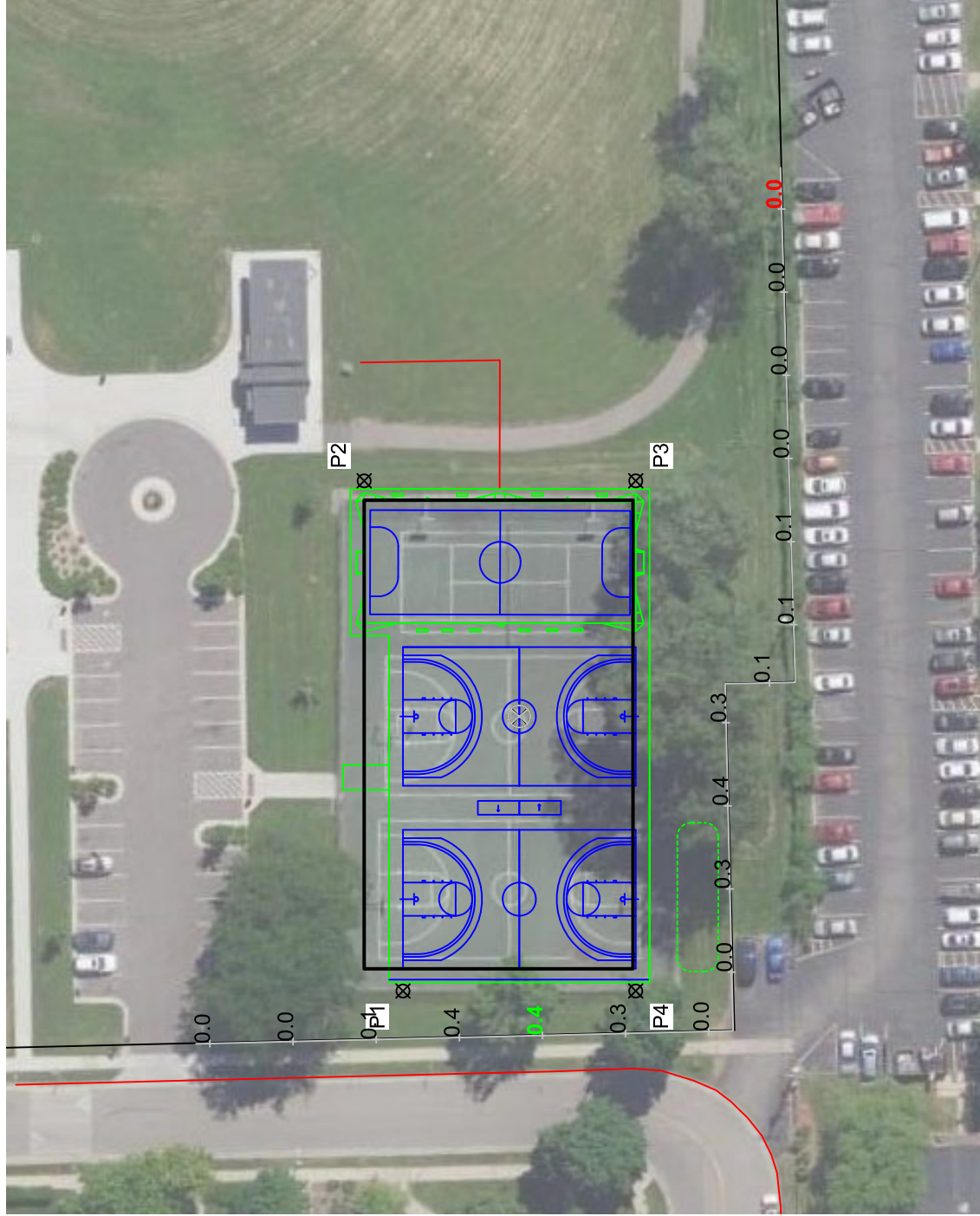

Pole location(s) ⊕ dimensions are relative to 0,0 reference point(s) ⊗

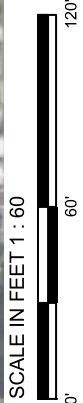

ENGINEERED DESIGN By: Connor Ramstead · File #224333B · 21-Dec-22



Not to be reproduced in whole or part without the written consent of Musco Sports Lighting, LLC. ©1981, 2022 Musco Sports Lighting, LLC.

ILLUMINATION SUMMARY

Penn Park Basketball Madison, WI

EQUIPMENT LAYOUT

INCLUDES:
- Courts

Electrical System Requirements: Refer to Amperage Draw Chart and/or the "Musco Control System Summary" for electrical sizing.

Installation Requirements: Results assume $\pm 3\%$ nominal voltage at line side of the driver and structures located within 3 feet (1m) of design locations.

EQUIPMENT LIST FOR AREAS SHOWN

Pole			Luminaires			
QTY	LOCATION	SIZE	GRADE ELEVATION	MOUNTING HEIGHT	LUMINAIRE TYPE	QTY/POLE
4	P1-P4	40'	-	40'	TLC-LED-600	2
TOTALS						8

SINGLE LUMINAIRE AMPERAGE DRAW CHART

Ballast Specifications (.90 min power factor)	Line Amperage Per Luminaire (max draw)			
	208 (60)	240 (60)	277 (60)	380 (60)
Single Phase Voltage	3.4	3.2	3.0	2.6
TLC-LED-600			2.0	1.9
			1.5	

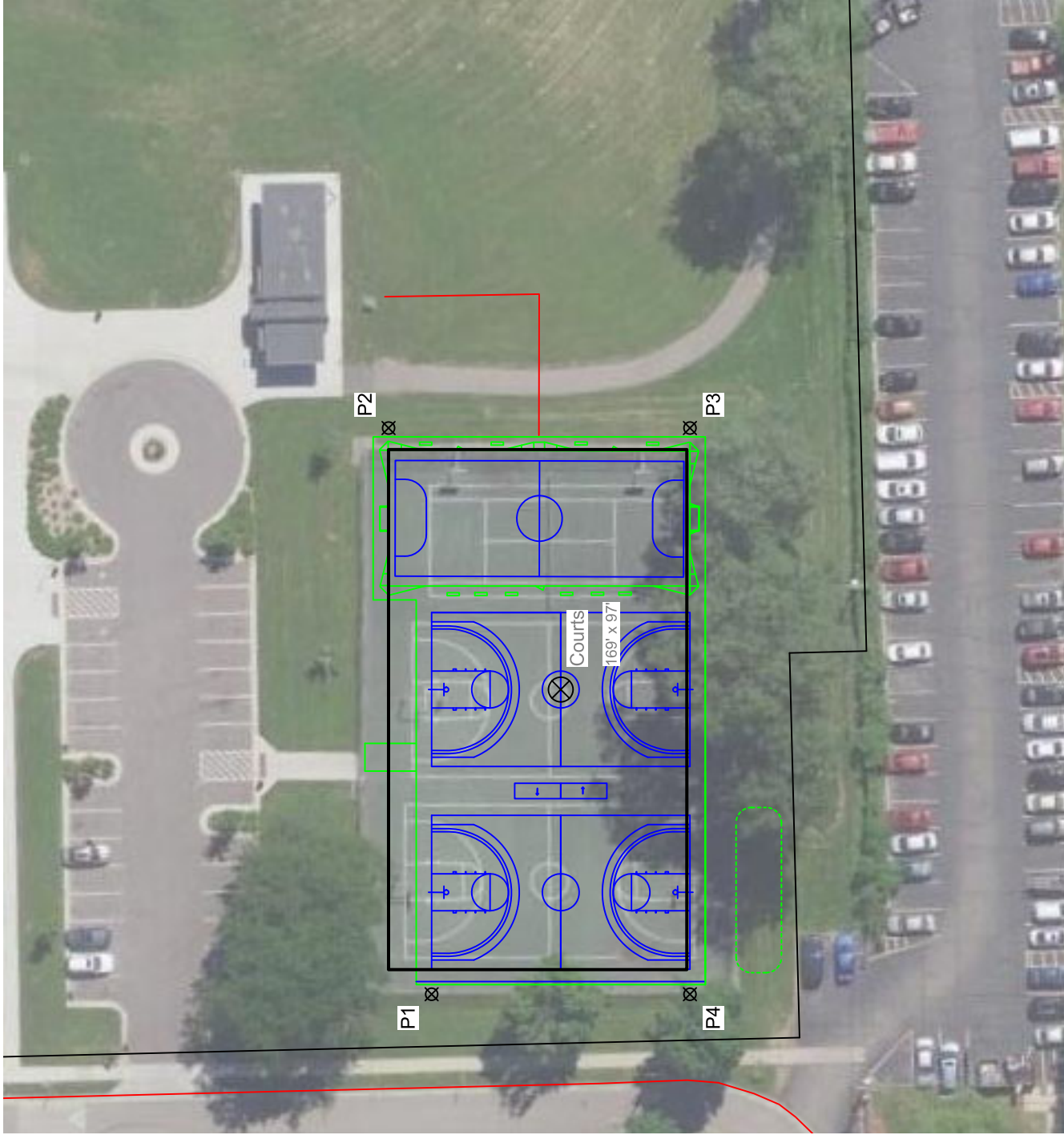

Pole location(s) \otimes dimensions are relative to 0,0 reference point(s) \otimes

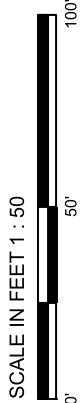

SCALE IN FEET 1 : 50
ENGINEERED DESIGN By: Connor Ramstead · File #224333B · 21-Dec-22



Not to be reproduced in whole or part without the written consent of Musco Sports Lighting, LLC. ©1981, 2022 Musco Sports Lighting, LLC.

EQUIPMENT LAYOUT